



INDIA TRADE PROMOTION ORGANISATION



INTERNATIONAL  
EXHIBITION  
cum  
CONVENTION  
CENTRE (IECC)  
Pragati Maidan, New Delhi

A Unique Symbol  
of

*New  
India*

# INTERNATIONAL EXHIBITION cum CONVENTION CENTRE (IECC)

## AREA STATEMENT - CONVENTION CENTRE

### CONVENTION CENTRE - LEVEL - 1 Floor to Floor Height : 5.4 m

S.NO.	DESCRIPTION	FLOOR AREA		DIMENSIONS (in m)	
		(in sq.m)	(in sq.ft)	L	B

PREMIUM COMPLEX					
1	PREMIUM MEETING ROOM (100 PAX)	197	2120	9.7	20.2
2	PREMIUM MEETING ROOM (50 PAX)	120	1291	12.5	9.5
3	BREAK OUT ROOM	28	297	3.9	7.1
4	PREMIUM PRE-FUNCTION AREA	139	1495	10.5	13.2
5	PREMIUM WAITING LOUNGE	38	414	6.4	6.0
6	PREMIUM DINNING LOUNGE	73	786	10.5	6.9

#### MEETING COMPLEX

1	MEETING ROOM (200 PAX) - 1	272	2928	21.3	13.0
2	MEETING ROOM (200 PAX) - 2	269	2896	21.2	13.0
3	MEETING ROOM (200 PAX) - 3	272	2928	21.0	13.0
4	MEETING ROOM (200 PAX) - 4	269	2896	21.0	13.0
5	MEETING ROOM (100 PAX) - 1	127	1368	10.2	12.7
6	MEETING ROOM (100 PAX) - 2	121	1368	10.2	12.7
7	MEETING ROOM (100 PAX) - 3	127	1368	10.2	12.7
8	MEETING ROOM (100 PAX) - 4	121	1303	10.2	12.7
9	MEETING ROOM (100 PAX) - 5	136	1460	10.3	12.7
10	MEETING ROOM (100 PAX) - 6	136	1460	10.3	12.7
11	MEETING ROOM (50 PAX) - 1	63	684	10.1	6.2
12	MEETING ROOM (50 PAX) - 2	63	684	10.1	6.2
13	MEETING ROOM (50 PAX) - 3	63	684	10.1	6.2
14	MEETING ROOM (50 PAX) - 4	63	684	10.1	6.2
15	MEETING ROOM (50 PAX) - 5	71	759	10.7	7.0
16	MEETING ROOM (50 PAX) - 6	71	759	10.7	7.0
17	MEETING ROOM (50 PAX) - Fixed -1	611	658	9.6	6.3
18	MEETING ROOM (50 PAX) - Fixed -2	61	656	9.6	6.3
19	MEETING ROOM (50 PAX) - Fixed -3	61	658	9.6	6.3
20	MEETING ROOM (50 PAX) - Fixed -4	61	656	9.6	6.3

#### SUPPORT FACILITIES

1	PRE-FUNCTION AREA	2229	23994	-	-
2	VIP RECEPTION	381	4104	-	-
3	GENERAL RECEPTION FOYER	482	5186	-	-

### CONVENTION CENTRE - LEVEL - 2 Floor to Floor Height : 9.0 m

S.NO.	DESCRIPTION	FLOOR AREA		DIMENSIONS (in m)	
		(in sq.m)	(in sq.ft)	L	B

G-20 SUMMIT MEETING ROOM					
1	G-20 MEETING ROOM (157 Fixed + 72 Floating PAX)	655	7048	26.0	26.0
2	BREAK OUT ROOM - 1	27	287	7.2	3.8

#### MEETING COMPLEX

1	MEETING ROOM (500 PAX) - 1 LEADERS' LOUNGE	581	6254	19.3	30.3
2	MEETING ROOM (500 PAX) - 2 LEADERS' DINING	581	6254	19.3	30.3
3	COMBINED MEETING ROOM (1000 PAX)	1162	12508	36.7	30.3
4	AUDITORIUM (900 PAX) - 1	932	10031	-	-
5	AUDITORIUM (900 PAX) - 2	704	7576	-	-

#### SUPPORT FACILITIES

1	VIP LOUNGE	182	1961	-	-
2	CAFÉ	184	1977	-	-
3	TEA HOUSE - 1 (ART GALLERY)	373	4015	-	-
4	TEA HOUSE - 2	387	4161	-	-
5	PRESIDENTIAL LOBBY	101	1082	-	-
6	PRE - FUNCTION AREA	-	-	-	-
7	RECEPTION	-	-	-	-

### CONVENTION CENTRE - LEVEL - 3 Floor to Floor Height varies

#### MULTI - FUNCTION AND PLENARY HALL

1	MULTI - FUNCTION HALL 1 (false ceiling height 11 to 12.2m) (1070 PAX)	969	10435	32.1	30.6
2	MULTI - FUNCTION HALL 2 (false ceiling height 11 to 12.2m) (1070 PAX)	969	10435	32.1	30.6
3	MULTI - FUNCTION HALL 3 (false ceiling height 11 to 12.2m) (840 PAX)	1243	13376	41.9	31.2
4	MULTI - FUNCTION HALL 4 (false ceiling height 11 to 12.2m) (840 PAX)	1243	13376	41.9	31.2
5	MULTI - FUNCTION HALL 1 AND 3 COMBINED (2100 PAX)	2078	22367	32.1	66.8
6	MULTI - FUNCTION HALL 2 AND 4 COMBINED (2100 PAX)	2656	28589	41.9	66.8
7	MULTI - FUNCTION HALL - ALL COMBINED (4240 PAX)	5132	55240	83.5	66.8
8	PLENARY HALL (false ceiling height 9.5 to 14 m) (3000 PAX)	3108	33450	-	-
9	MULTI - FUNCTIONAL AND PLENARY HALL COMBINED (7720 PAX)	8239	88690	-	-

#### SUPPORT FACILITIES

1	PRE - FUNCTION (Height varies from 5.8 to 12.5m)	2720	29278	-	-
2	SPECIAL LOUNGE (Floor to Floor height - 6.9m)	104	1118	-	-
3	SPECIAL LOBBY (Floor to Floor height - 6.9m)	67	725	-	-

### CONVENTION CENTRE - LEVEL - 4 False Ceiling Height : 6.5 - 8 m

S.NO.	DESCRIPTION	FLOOR AREA		DIMENSIONS (in m)	
		(in sq.m)	(in sq.ft)	L	B

SUPPORT FACILITIES					
1	PRE - FUNCTION EXCLUDING PLENARY AND MULTI FUNCTION HALL	1891	20353	-	-

### CONVENTION CENTRE - LEVEL - 5 Floor to Bottom of Truss Height : 2.7 m

#### SUPPORT FACILITIES

1	AV LOUNGE	40	434	-	-
2	PRESS LOUNGE L5-PR-L0-L1	36	390	-	-
3	PRESS LOUNGE L5-PR-L0-L2	36	390	-	-
4	INTERPRETER ROOMS L5 - INTP - 01	59	638	-	-
5	INTERPRETER ROOMS L5 - INTP - 02	39	420	-	-
6	INTERPRETER ROOMS L5 - INTP - 03	47	511	-	-
7	INTERPRETER ROOMS L5 - INTP - 04	47	511	-	-
8	INTERPRETER ROOMS L5 - INTP - 05	39	419	-	-
9	INTERPRETER ROOMS L5 - INTP - 06	59	638	-	-
10	INTERPRETER ROOMS SUB - TOTAL	291	3137	-	-

### AMPHITHEATRES

1	AMPHITHEATRE NEAR CONVENTION CENTRE (BELOW PLENARY)	3000 pax
2	AMPHITHEATRE NEAR HALL 14	900 pax
3	AMPHITHEATRE NEAR HALL 2	900 pax
4	AMPHITHEATRE NEAR HALL 5	900 pax
5	AMPHITHEATRE NEAR LAKE	450 pax

In Convention Centre, live-load bearing capacity of all floors is approx 0.5 Tonne/Sq.m. and roof is 0.2 Tonne/Sq.m.



# Layout Plan of International Exhibition cum Convention Center (IECC) Pragati Maidan, New Delhi

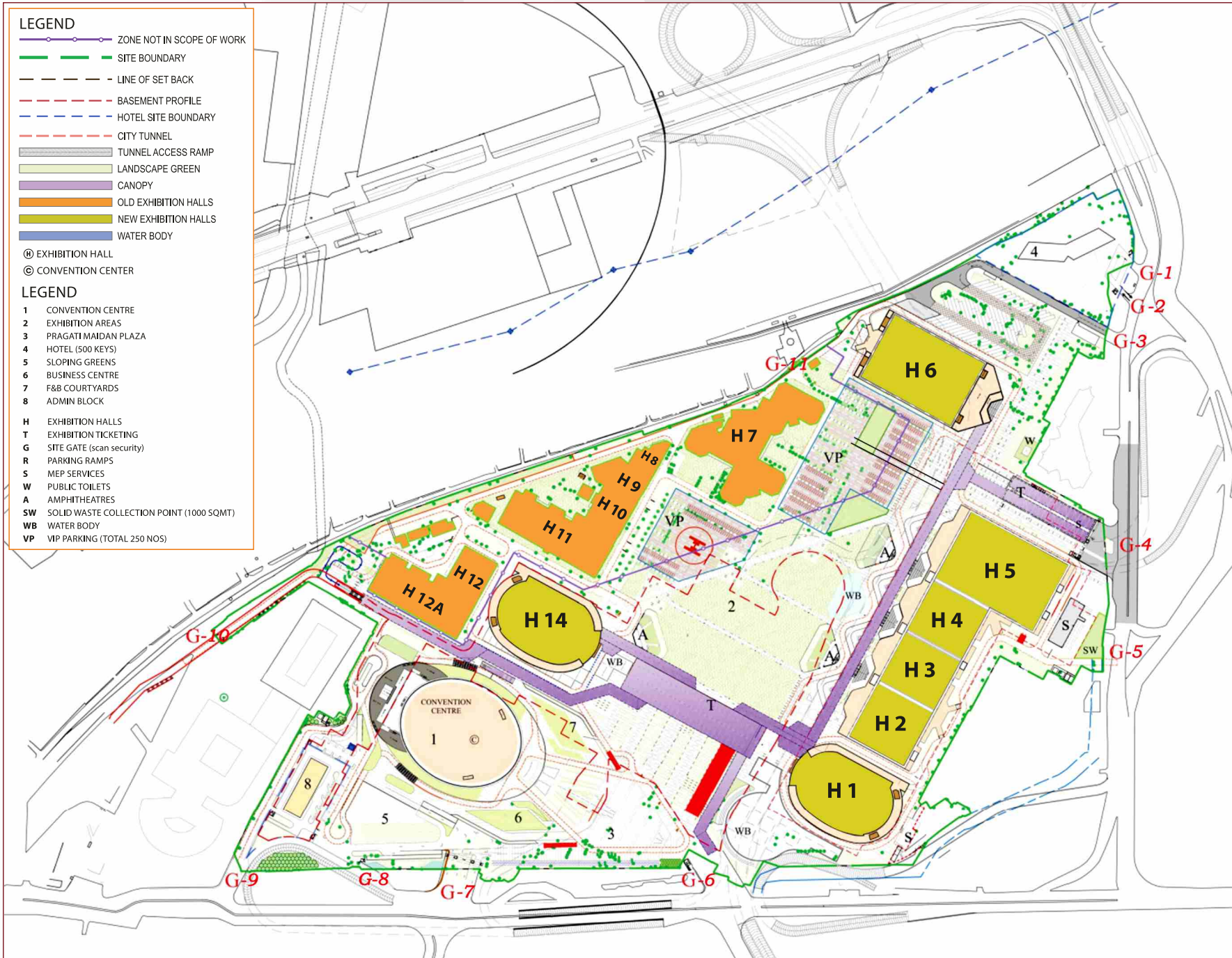



INDIA TRADE PROMOTION ORGANISATION



## INTERNATIONAL EXHIBITION cum CONVENTION CENTRE (IECC)

ITPO is now implementing its ambitious plan of re-development of its landmark fairground Pragati Maidan, involving a modern state-of-the-art International Exhibition-cum-Convention Centre (IECC) in two phases, bringing it at par with the best Exhibition and Convention Centres across the world.



To experience a virtual walkthrough of IECC please scan the QR code with your mobile device.



INDIA TRADE PROMOTION ORGANISATION

## Promoting 'India' Brand Globally...

India Trade Promotion Organisation (ITPO) as the nodal trade promotion agency of the country, has had a pioneering role in the national trade growth dynamics since its inception. Apart from its role in bringing the Indian business particularly those in the SMEs sector closer to global markets, it pioneered use and popularisation of trade fairs as a tool for trade promotion within the country and abroad. A nonprofit company under Section 25 of Companies Act 1956, it was formed on January 1, 1992 with the merger of the former Trade Development Authority (TDA) with the Trade Fair Authority of India (TFAI). Earlier, the TFAI was formed on April 1, 1977.

### Vision

ITPO's vision envisages to be a leader amongst world class trade promotion organisations leveraging India's strengths internationally. It also envisages rapid growth in India's share of global trade and investments quality of our services and customer satisfaction.

### Mission

ITPO's mission is to promote, facilitate encourage and coordinate various activities and programmes to enhance India's share of export through trade in goods.

## ITPO Organises

- Dissemination of trade information through meetings, seminars and workshops, online fortnightly 'Indian Export Bulletin' and online trade portal, [www.tradeportalofindia.com](http://www.tradeportalofindia.com).
  - Trade Exhibitions in India and appropriate facilitation
- India pavilions in product specific fairs and exclusive India Shows overseas
  - Buyer-Seller Meets (BSMs)
- Trade related seminars, conferences, workshops and networking events.

### HEAD OFFICE

Pragati Bhawan, Pragati Maidan, New Delhi-110001 (India)

Tel: 91-11-23371540 (EPABX), Fax: 91-11-23371492

E.mail: [info@itpo.gov.in](mailto:info@itpo.gov.in) Website: [www.indiatrdefair.com](http://www.indiatrdefair.com) Trade Portal: [www.tradeportalofindia.com](http://www.tradeportalofindia.com)

For booking please contact :

#### Sh. Devender Pal

Dy. General Manager & Single Point Contact

Mobile : +91-9810994832

E-Mail : [devenderpal@itpo.gov.in](mailto:devenderpal@itpo.gov.in)

#### Sh. Surinder Kumar

Senior Manager

Mobile : +91-9810960930

E-Mail : [ksurinder@itpo.gov.in](mailto:ksurinder@itpo.gov.in)

Member of:

